

<u>BNPM/OTE/100/2023- 24</u>	BANK NOTE PAPER MILL INDIA PRIVATE LIMITED	
	CORRIGENDUM No. 1 <u>SUPPLY OF MECHANICAL SEALS AT BNPM PLANT, MYSURU</u>	

CORRIGENDUM No. 1 DATED 05.06.2023

FOR

TENDER No.

BNPM/OTE/100/2023-24 dated 23.05.2023

PURCHASER	:	BANK NOTE PAPER MILL INDIA PRIVATE LIMITED
MATERIAL	:	SUPPLY OF MECHANICAL SEALS AT BNPM PLANT, MYSURU
LOCATION	:	BNPM PLANT, MYSURU, KARNATAKA



<u>BNPM/OTE/100/2023-24 dated 23.05.2023</u>	BANK NOTE PAPER MILL INDIA PRIVATE LIMITED	
	CORRIGENDUM No. <u>SUPPLY OF MECHANICAL SEALS AT BNPM PLANT, MYSURU</u>	

1.0 **SCOPE OF THIS CORRIGENDUM**

1. Details provided in this corrigendum shall override those mentioned in the tender no. BNPM/OTE/100/2023-24 dated 02.06.2023.

2. Except for details mentioned herein, all other details contained in the tender no. BNPM/OTE/100/2023-24 dated 02.06.2023 shall remain unchanged.

3. **Amendment to requirements :-**

i) Refer tender Section VII, Technical Specifications to be read as:-

S. No	Item	Specification as per tender	Specifications to be read as
1	Supply of Mechanical seal for Sulzer Pump (NPP/APP - 2series)	Technical Details: <ul style="list-style-type: none"> Mechanical seal for Sulzer Pump (NPP/APP - 2 series) Size : 40MM MOC of the seal body : SS316L Face combination of seal : SC/SC 	Technical Details: <ul style="list-style-type: none"> Shaft Size - 40MM Pressure on seal/stuffing box pressure - 6Kg/cm2 Fluid being pumped - Cotton Pulp (<4 % Consistency) Temperature - 70° C (max) Shaft Speed - 3000 rpm (max) Existing seal drawing if any - Refer below mentioned drawing Stuffing box cavity details - MOC Seal Body /Spring - SS316L Seal face material (Sealing / Thrust)- SIC/SIC
2	Supply of Mechanical Seal 50MM , Model No: SEW-AP-50-GREV-305319 for Sulzer pump NPP 31- 100	Technical Details :- <ul style="list-style-type: none"> Mechanical seal with v ring plate with V seal 50MM Mechanical Seal thrust Material : SiC 	Technical Details: <ul style="list-style-type: none"> Mechanical seal with v ring plate with V seal 50MM Elastomes MOC : EPDM Shaft Size - 50MM

<u>BNPM/OTE/100/202</u> <u>3-24 dated</u> <u>23.05.2023</u>	BANK NOTE PAPER MILL INDIA PRIVATE LIMITED		
	CORRIGENDUM No. <u>SUPPLY OF MECHANICAL SEALS AT BNPM PLANT,</u> <u>MYSURU</u>		
		<ul style="list-style-type: none"> • Mechanical Seal Face material : Car • Elastomes MOC : EPDM • Seal Hardware : SS 316 • Pump Make : Sulzer • Pump Model : NPP 31-100 • Shaft Size : D50MM • Seal Make : John Crane • Mechanical Seal Model : SEW-AP-50-GREV-305319 	<ul style="list-style-type: none"> • Pressure on seal/stuffing box pressure - 6Kg/cm2 • Fluid being pumped - Cotton Pulp (<4 % Consistency) • Temperature - 70° C (max) • Shaft Speed - 3000 rpm (max) • Existing seal drawing if any - Refer below mentioned drawing • Stuffing box cavity details • Seal Body /Spring - SS316L • Seal face material (Sealing / Thrust) - SIC/SIC • Existing Pump Make : Sulzer • Pump Model : NPP 31-100 • Seal Make : John Crane/ Any Equivalent. • Equivalent to Mechanical Seal Model : SEW-AP-50-GREV-305319 • Drawings are as per below.
3	Supply of Mechanical seal	Mechanical seal Gr.35 MG1-G60/Q1QVGG	Technical Details: <ul style="list-style-type: none"> • Shaft Size - 35 mm • Pressure on seal/stuffing box pressure- 6 bar (max). • Fluid being pumped- Titanium dioxide slurry (20% solids; pH : 6-8; sp. gr: 1.2kg/dm³; particle size: 0mm; kinetic viscosity: 12.5 mm²/s. • Temperature - 50° C (max) • Shaft Speed - 250 rpm (max) • Existing seal drawing if any - Refer below mentioned drawing • Stuffing box cavity details- Refer below mentioned drawing • Equivalent to Mechanical seal Gr.35 MG1-G60/Q1QVGG

<u>BNPM/OTE/100/202</u> <u>3-24 dated</u> <u>23.05.2023</u>	BANK NOTE PAPER MILL INDIA PRIVATE LIMITED	
	CORRIGENDUM No. <u>SUPPLY OF MECHANICAL SEALS AT BNPM PLANT,</u> <u>MYSURU</u>	

4	Supply of Mechanical seal for Sulzer Pump (APP - 31); equivalent to model : SE1-AP - 50 - QREO (John Crane)	Mechanical seal for Sulzer Pump (APP - 31); equivalent to model : SE1-AP - 50 - QREO (John Crane)	Technical Details: <ul style="list-style-type: none"> • Shaft Size - 50 mm • Pressure on seal/stuffing box pressure- 6 bar (max). • Fluid being pumped- cotton pulp(<4% Consistency) • Temperature - 70° C (max) • Shaft Speed - 3000 rpm (max) • Existing seal drawing if any - Refer below mentioned drawing • Stuffing box cavity details- Refer below mentioned drawing • equivalent to model : SE1-AP - 50 - QREO (John Crane)
---	---	---	--

ii. Ref Image/ Drawings as mentioned below

1. Supply of Mechanical seal for Sulzer Pump (NPP/APP - 2series)



<u>BNPM/OTE/100/202</u> <u>3-24 dated</u> <u>23.05.2023</u>	BANK NOTE PAPER MILL INDIA PRIVATE LIMITED	
	CORRIGENDUM No. <u>SUPPLY OF MECHANICAL SEALS AT BNPM PLANT,</u> <u>MYSURU</u>	

2. Supply of Mechanical Seal 50MM , Model No: SEW-AP-50-GREV-305319 for Sulzer pump NPP 31- 100

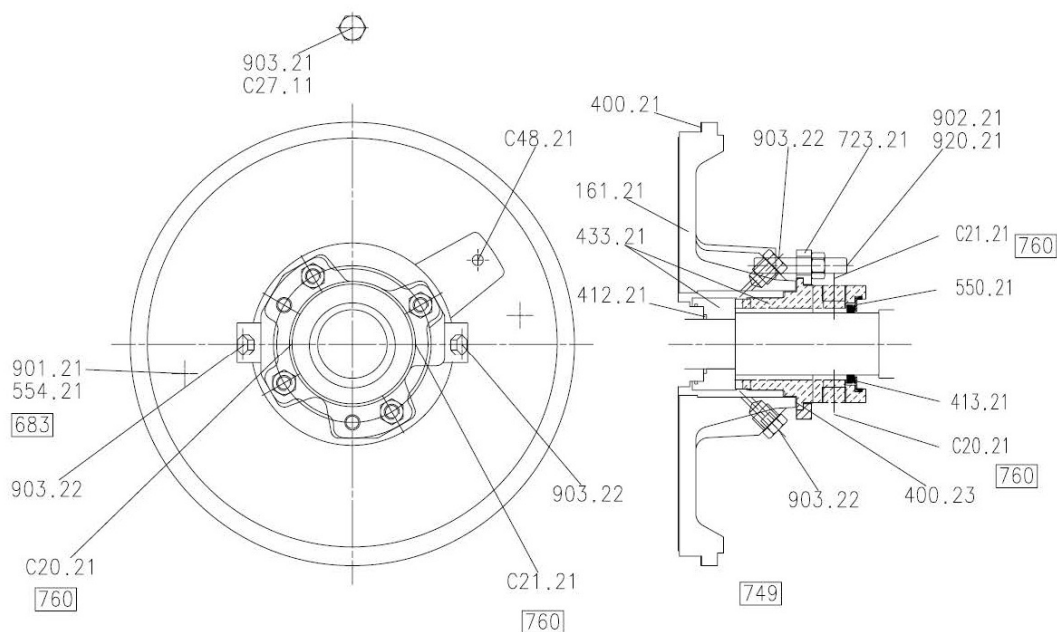

BNPM/OTE/100/202 3-24 dated 23.05.2023	BANK NOTE PAPER MILL INDIA PRIVATE LIMITED	
	CORRIGENDUM No. SUPPLY OF MECHANICAL SEALS AT BNPM PLANT, MYSURU	

3. Supply of Mechanical seal Gr.35 MG1-G60/Q1QVGG

DIMENSIONAL DRAWING

Working Length (LE) : 28.5 mm
Free Length (LF) : 32 mm
Compressed Length (f) : 3.5

POS	DESCRIPTION	MATERIAL	QTY
1.1	SEAL FACE	SIC (Q1) SINTERED SILICON CARBIDE	01
1.2	BELLOW	FKM (FLUOROCARBON)	01
1.3	CORNER RING	SS 316	01
1.4	CORNER RING	SS 316	01
1.5	SPRING	SS 316	01
2	STATIONARY SEAL	SIC (Q1) SINTERED SILICON CARBIDE	01
3	L RING	FKM (FLUOROCARBON)	01

IMAGE

ALL DIMENSIONS ARE IN MM UNLESS UNTIL SPECIFIED

BANK NOTE PAPER MILL INDIA PRIVATE LIMITED
MYSORE-570003

	SIGNATURE	DATE	MECHANICAL SEAL- Gr.35 MG1-G60/Q1Q1VGG
PREPARED BY			
CHECKED BY			MOC :SS 316
APPROVED BY			DRG.NO:BNPM/PM/248/2023-24

<u>BNPM/OTE/100/202</u> <u>3-24 dated</u> <u>23.05.2023</u>	BANK NOTE PAPER MILL INDIA PRIVATE LIMITED	
	CORRIGENDUM No. <u>SUPPLY OF MECHANICAL SEALS AT BNPM PLANT,</u> <u>MYSURU</u>	

iv) Refer tender Section VIII, Quality Control Requirements to be read as:-

S. No	Item Description	Features	Whether agreed by the bidder	Deviation if any
1	Supply of Mechanical seal for Sulzer Pump (NPP/APP - 2series)	Technical Details: <ul style="list-style-type: none"> • Shaft Size - 40MM • Pressure on seal/stuffing box pressure - 6Kg/cm2 • Fluid being pumped - Cotton Pulp (<4 % Consistency) • Temperature - 70° C (max) • Shaft Speed - 3000 rpm (max) • Existing seal drawing if any - Refer attached drawing • Stuffing box cavity details - • MOC Seal Body /Spring - SS316L • Seal face material (Sealing / Thrust) - SIC/SIC 	Yes agreed	
2	Supply of Mechanical Seal 50MM , Model No: SEW-AP-50-GREV-305319 for Sulzer pump NPP 31- 100	Technical Details: <ul style="list-style-type: none"> • Mechanical seal with v ring plate with V seal 50MM • Elastomes MOC : EPDM • Shaft Size - 50MM • Pressure on seal/stuffing box pressure - 6Kg/cm2 • Fluid being pumped - Cotton Pulp (<4 % Consistency) • Temperature - 70° C (max) • Shaft Speed - 3000 rpm (max) • Existing seal drawing if any - Refer below mentioned drawing • Stuffing box cavity details 	Yes agreed	

<u>BNPM/OTE/100/202</u> <u>3-24 dated</u> <u>23.05.2023</u>		BANK NOTE PAPER MILL INDIA PRIVATE LIMITED		
		CORRIGENDUM No. <u>SUPPLY OF MECHANICAL SEALS AT BNPM PLANT,</u> <u>MYSURU</u>		
		<ul style="list-style-type: none">Seal Body /Spring - SS316LSeal face material (Sealing / Thrust) - SIC/SICExisting Pump Make : SulzerPump Model : NPP 31-100Seal Make : John Crane/ Any Equivalent.Equivalent to Mechanical Seal Model : SEW-AP-50-GREV-305319Refer attached drawing.		
3	Supply of Mechanical seal Gr.35 MG1-G60/Q1QVGG	Technical Details: <ul style="list-style-type: none">Shaft Size - 35 mmPressure on seal/stuffing box pressure- 6 bar (max).Fluid being pumped- Titanium dioxide slurry (20% solids; pH : 6-8; sp. gr: 1.2kg/dm³; particle size: 0mm; kinetic viscosity: 12.5 mm²/s.Temperature - 50° C (max)Shaft Speed - 250 rpm (max)Existing seal drawing if any - Refer attached drawingStuffing box cavity details- Refer attached drawingEquivalent to Mechanical seal Gr.35 MG1-G60/Q1QVGG	Yes agreed	
4	Supply of Mechanical seal for Sulzer Pump (APP - 31); equivalent to model : SE1-AP - 50 - QREO (John Crane)	Technical Details: <ul style="list-style-type: none">Shaft Size - 50 mmPressure on seal/stuffing box pressure- 6 bar (max).Fluid being pumped- cotton pulp(<4% Consistency)Temperature - 70° C (max)Shaft Speed - 3000 rpm (max)	Yes agreed	

Page 9 of 11

<u>BNPM/OTE/100/202</u> <u>3-24 dated</u> <u>23.05.2023</u>	BANK NOTE PAPER MILL INDIA PRIVATE LIMITED	
	CORRIGENDUM No. <u>SUPPLY OF MECHANICAL SEALS AT BNPM PLANT,</u> <u>MYSURU</u>	

		<ul style="list-style-type: none"> Existing seal drawing if any - Refer attached drawing Stuffing box cavity details- Refer below mentioned drawing equivalent to model : SE1-AP - 50 - QREO (John Crane) 		
--	--	--	--	--